



AC3 SERIES



HIGH FREQUENCY

Inductance Range (nH)	DCR max (mOhms)	Current Rating (Amps)
1.65 to 43	20	1.2 to 3

ELECTRICAL SPECIFICATIONS

- **Operating Temperature:** -55°C to +125°C
- **Storage Temperature:** -60°C to +130°C
- **Temperature Rise @ 90°C:** < 30°C
- **Standard Co-Planarity** is 0.010"
- **For 0.005" Co-Planarity**— Add -005 to the end of part number

FEATURES

- **Low Thermal Expansion** permits mounting on most substrate material
- **Automatic Placement:** Protective epoxy coating on top surface for ease of auto placement
- **High operating frequency range** allows for usage in multiple applications
- **Exceptionally high Q value** over wide frequency range
- Terminations are tin-lead coated

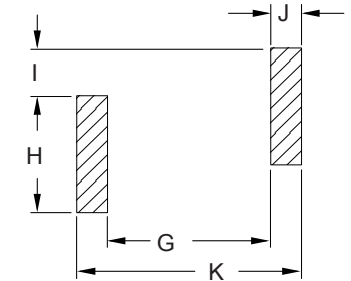
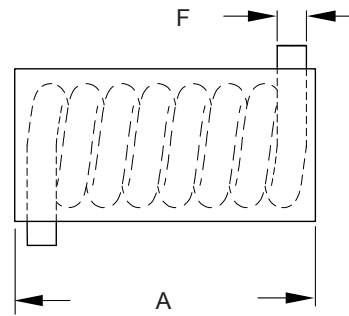
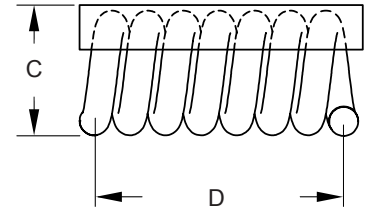
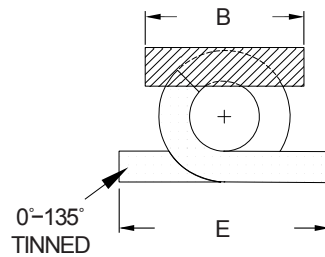
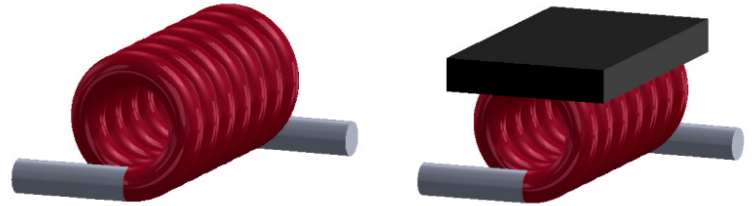

RECOMMENDED MOUNTING PAD CIRCUIT SIDE

Vanguard Part Number	A (MAX)	B	C (MAX)	D	E (MAX)	F (MAX)	G (REF)	H (REF)	I (REF)	J (REF)	K (REF)
AC3-01	.155	.125 ±.010	.124	.115 ±.010	.175	.029	.080	.130	.040	.035	.145
AC3-02 thru AC3-06	.270	.125 ±.010	.124	.230 ±.015	.175	.029	.200	.130	.040	.035	.260
AC3-07 thru AC3-10	.095	.055 ±.010	.060	.072 ±.010	.135	.020	.050	.100	.030	.026	.092
AC3-11 thru AC3-15	.165	.055 ±.010	.062	.144 ±.012	.135	.020	.120	.100	.030	.026	.165

*Dimensions are in inches.



